

The Haymarket

Technical Specifications

The Haymarket, Wote Street, Basingstoke, Hampshire, RG21 7NW
01256 819797

Production Manager	elfie.courcoult@anvilarts.org.uk Ext: 118
Technical Manager	ben.allen@anvilarts.org.uk Ext: 128
Production Administrator	amanda.wise@anvilarts.org.uk Ext: 164
Programme Manager	ann.dickson@anvilarts.org.uk Ext: 111

Updated 2024



Contents

Stage / Flying	3
Get In	4
Power Supplies	4
Communications	5
Dressing Room Facilities	6
Formats	7
Orchestra Pit	8
Stage Equipment and Masking	8
Lighting	9
Mixer Positions	10
Sound	10 – 12
Data Projector and Screen	13
Appendix A – Stage and Ground Plans	14

Stage / Flying

Stage Plan: See Appendix A

General	Proscenium Opening	8970mm x 5000mm
	Setting Line to Back Wall	8030mm at Centre Line
	Setting Line to Full Black	7200mm
	Setting Line to Edge of Stage	1450mm
	Setting Line to Edge of Forestage Extension	3100mm
	Depth of Forestage Extension	1640mm
	Height of Stage from Stalls Level	940mm
Distance to house LX Bars from Setting Line	LX1 – 600mm	
	LX2 – 2200mm	
	LX3 – 3800mm	
	LX4 – 5600mm	
	LX5/ Flood Bar – 6200mm	

Flying	Height to Underside of Fly Floor	6350mm
	Height to Grid	10230mm
	Width Between Fly Galleries	

SWL = Safe Working Load / PL = Single Point Load

		Quantity
Advance Truss	(500kg SWL) (PL 55kg)	1
House Curtain Bar	(175kg SWL) (PL 55kg)	1
Motor Bars	(300kg SWL) (PL 60kg)	5
Upstage Truss	(500kg SWL) (PL 55kg)	1
Hemp Sets (non-counterweighted)	(110kg SWL) (PL55kg)	29
Bar Lengths		10000mm

Please see appendix A for stage and ground plans

Get In

Access to stage is not level and requires either the use of the auditorium pit lift or winch system at the dock door. The dock door is +4200mm above ground level and all items must be winched in from ground level by a single pickup motor hoist.

Max Dimensions for Get Ins: Via Dock door @ +4200mm (h) 2.5M x 5.3M
 Via Stage Door/Pit Lift 2.4M Diagonal

Power Supplies

Visiting Lighting Supply
Located DSR

1 x 63A 3 Phase Ceeform Socket
1 x 63A Single Phase Ceeform Socket
1 x 32A Single Phase Ceeform Socket
2 x 16A Single Phase Ceeform Sockets

Visiting Sound Supply
Located DSL

1 x 32A Single Phase Ceeform Socket

Stage Locals

A mixture of 13A and 15A sockets located around the stage, fly gallery, front of house bridge and auditorium

Selection of 32a to 16a step down distribution boxes.

Selection of 16a to 13a step down distribution boxes.

Selection of 32a and 16a cable.

Selection of 13a extensions

Communications

Stage Manager's desk situated DSR comprising:

- Cue Lights control station
- Infrared stage video monitor
- Show timer
- FOH and Backstage Paging
- A belt pack and headset intercom attached to the desk

Intercom comprising:

- 10 x 1 channel belt packs and headsets
- 9 x Cue lights

Additional communications including:

- 2 Channel IR audio descriptive system
- Video Show Relay
- Stage Video Patch System
- Video, audio and data running to various points around the stage and auditorium.

Dressing Room Facilities

- 2 x En-suite dressing rooms suitable for 1 or 2 performers (D & C)
- 2 x Large Chorus dressing rooms suitable for a maximum of 20 performers each
- 1 x Dressing room suitable for up to 4 people (B)
- 1 x Dressing Room suitable for 4 people / Visiting Company Managers Room (A)
- 1 x Additional Performer Storage Room
- 1 x laundry room

Each dressing room has a safe for personal possessions.

There are 5 toilets which are used by staff and performers.

The Dressing rooms are at Stage Door level and the Stage is up a flight of stairs.

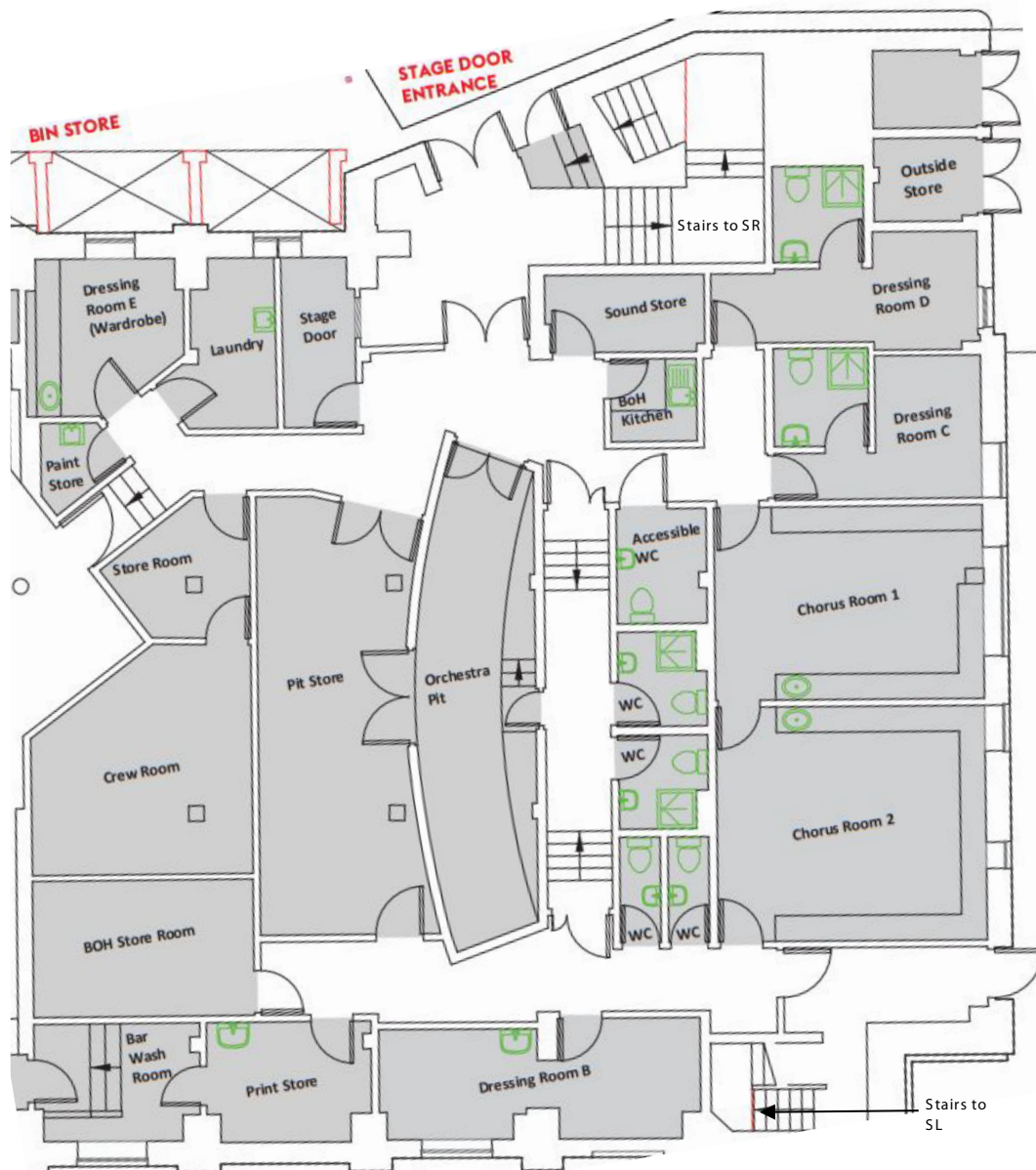

Formats

The Auditorium Pit Elevator can be used in 3 positions.

1. At stage level to create a stage extension
2. At Auditorium level (usual position)
3. At Orchestral Pit Level



Orchestra Pit

An orchestra pit is available in some formats. 13A Power is available in the Orchestra pit. 12 Music stands and 12 chairs are available for use in the pit. Please see Appendix A for a section showing pit positions.

Stage Equipment and Masking

A selection of hard masking flats is available to create a variety of formats. To supplement this, the following are also available:

Full White Cyclorama		X 1
Full Blacks	Permanently Rigged	X 2
Mid Blacks	Permanently Rigged	X 2
Black Gauze		X 1
White Gauze		X 1
Thin Black Blinders		X 2
Tab Swipe Track		X 1
Curtain Track		X 1
Black Masking Book Flats		X 2
Treads for auditorium/stage access		X 2
8' x 4' Lite Deck		X 2
Black Armless Chairs		X 12
Round Table – Adjustable Height		X 1
Black Stools		X 3
Music Stands		X 12
Assorted Stage Weights	(12.5kg and 25kg)	
Assorted Clothes Rails		
Assorted Folding Tables		

House tabs can only be swiped, not flown. We can hide the house tabs if they're not required for your performance.

Dip Traps run the depth of the stage at either side and underneath the Iron. These can be seen on the plans in Appendix A.

Black Harlequin dance floor is available to cover the entire stage and stage extension on request.

Lighting

Control:	1	x	ETC Ion XE20 4 x DMX Universes, EOS 40 fader wing
Dimmers:			ETC Sensor – 205 Dimmer Channels 20 Non Dim Circuits
Lanterns:	35	x	Selecon RAMA 1.2K Fresnel
	13	x	Floor Cans (5 Black and 6 Silver)
	28	x	Par 64 (CP62 standard & CP60 & 61 also available)
	2	x	Selecon 2.5K Arena Theatre Fresnel
	30	x	ETC Source 4 w/ 19/26/36 degree lens tubes 1 x 50 degree lens and 1 x 10 degree lens
	12	x	ETC Source 4 Zoom (Rigged on FOH Bridge)
	19	x	ETC Source 4 Jnr Zoom (25/50 lens)
	17	x	CODA 1K Cyc Flood
	1	x	ETC Source 4 Jnr (Fixed 36 degree) Assorted Birdies
Intelligent:	7	x	Clay Paky Alphaspot HPE300 (vector mode)
	6	x	ETC Colorsource Pars (Deep Purple)

Gobo Holders and Irises are available on request.

Sound

Mixer Positions

FOH Mixing Position Footprint Measurements

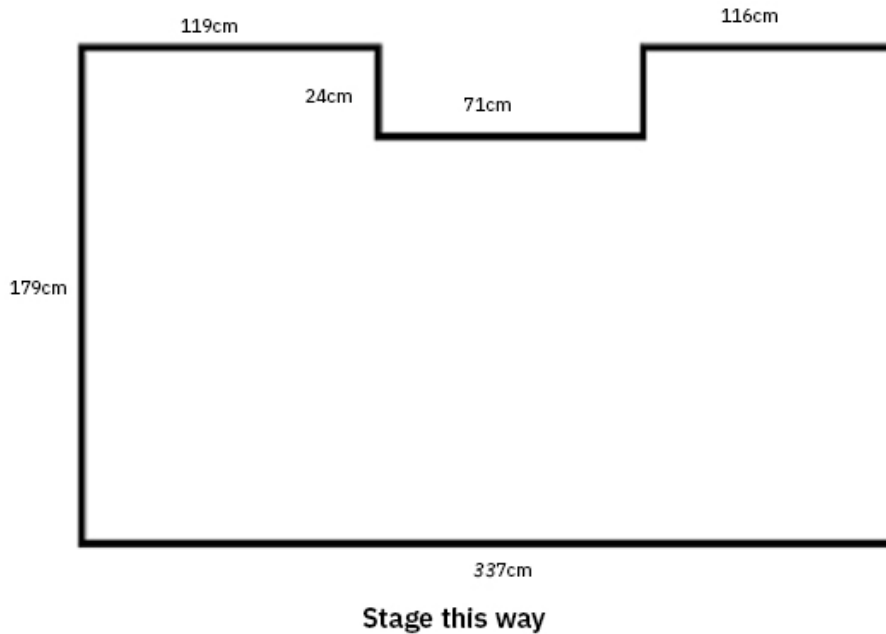

Plan not to scale

There are two available mix positions for FOH. One is sited at the rear of the stalls underneath the circle balcony. This position is suitable for larger consoles and has a clear view of the stage. Only 13a power is available at this mixing position. No seating requires removing to use this position.

N.B Visiting companies please be aware; this mix position can accommodate most consoles. However some larger consoles will not fit due to space restrictions.

The second is located inside the control room. There is a sliding glass window which can be moved to allow a clear listening position of the P.A. This position is not suitable for large or digital consoles due to restricted space and no multicore run. Only 13a power is available at this mixing position.

Tie lines around located around the stage and auditorium allowing you to patch into the house system from a variety of locations.

Amplification

All amplification for the P.A system is provided by Full Fat Audio.

P.A System

P.A system built around a ground stacked EM Acoustics system. This is supplemented with various delays around the auditorium for extra stalls and circle coverage.

Stalls Level Stereo PA

2 x EMS 152 Full Range
2 x EMS 81 Stalls in fills
1 x EMS 81x Stalls centre fill mounted above proscenium

Subwoofers

2 x i12 ULF subwoofer
2 x EMS 215 subwoofer

Circle Level Stereo PA

2 x EMS 122 Full Range

Delays

2 x EMS 61 on rear of lighting bridge

Processing

1 x XTA DP 448- Main PA and Delays
1 x XTA DP 424- Subwoofers

Control

Midas M32 (32 Mono inputs + 6 Stereo; 25 Mix buses)
2 x Midas DL16 stage boxes (16 mono inputs, 8 mono outputs, total 32 inputs, 16 outputs)

Monitor Speakers

6 x EM Acoustics M10 floor monitors

Multicores

32/4 analogue multicore installed running to stage left from stalls mixer position.
Cat5e UTP multicore installed running stage left from the stall's mixer position.
Cat5e UTP multicore reel 50m can either run to Stage left (preferred) or stage right.
12 Channel XLR Satellite box
1 x 12 Channel Return cable. (Used for L, R, Mono, Monitors)
2 x 12 Channel Send cable

Playback

2 x Denon CD player
2 x Tascam Minidisk player
1 x Apple Mac Book pro with Qlab 3, 4 and 5

Radio Microphone system

12 x Sennheiser EM500 G3 receivers (Four receivers to a flight case with 1 x antenna splitter)
3 x ASA1 antenna splitter
12 x Sennheiser SK500 G3 belt pack transmitters
4 x Sennheiser E965 wireless handheld Microphone
14 x Pulse 3200LJ headset microphones
12 x MKE2 mic beige
4 x MKE2 mic black
2 x A1031 omnidirectional antenna
4 x A2003 directional antenna
4 x AB3 GB range masthead amplifier
3 x Powercon – 13a

***PLEASE NOTE: The above microphones are used across all our venues so please contact the Production Department to check availability.**

Anvil Arts is currently licenced by Ofcom to use frequencies on channel 38 (606.500 MHz to 612.000 MHz).

A good selection of microphones, cables, D.I boxes, adaptors, stands and other equipment is available. Please contact the Production Department for a full audio equipment inventory.

Data Projector and Screen

*** PLEASE NOTE: The projector is used across The Anvil and The Haymarket so please contact the Production Department to check availability.**

Projector / Lens / Rigging:

Panasonic PT-DZ 13K DLP Projector
Panasonic ET-D75 LE6 0.9-1.1:1 Zoom Lens
Panasonic ET-RFD91 Projector Cradle
KPM Flying Bracket

Cabling / Distribution:

1x CYP PU-507TX-1H 1:1 HDBaseT HDMI/LAN/IR/RS-232/PoE Twisted Pair Transmitter with HDMI Loop
(Max. 100m at 1080p or 4K; 1 x HDMI input; 1 x HDBaseT, 1 x HDMI output)

1 x 45m run of Kramer C-HDK6/HDK6-150 RJ-45 Four-Pair U/FTP Cable (23AWG)
Optimized for HDBaseT

1 x 4.6 m Kramer C-DPM/HM-15 DisplayPort to HDMI (M-M)

Assorted VGA runs (50m)

1 x Roland V-4EX Vision Mixer

Screen:

Front / Rear Projection Screen & Frame (12' x 9')

Please contact the Production Department for hire prices and availability.

